

Name	Material	Surfaced process
Handle	Bakelite (KU)	Black
Spindle	Steel (ST)	Zincing (ZI)

mm

ORDER NO.	A	B	C	THREAD L		CODE NO.
VRL-8H	20	M8x1.25P	56	13	14	7003-283A
VRL-8HA	22	M8x1.25P	76	13	14	7003-284A
VRL-10H	20	M10x1.5P	56	13	14	7003-285A
VRL-10HA	22	M10x1.5P	76	13	14	7003-287A
VRL-10HB	25	M10x1.5P	83	13	14	7003-288A



360° Swivelling Lock Handle

360° Swivel Handle

- When pull out, this handle can swivel 360° free.
- Aluminium handle, all water resistance.
- The handle shape features: curve, ball, square 3 types.

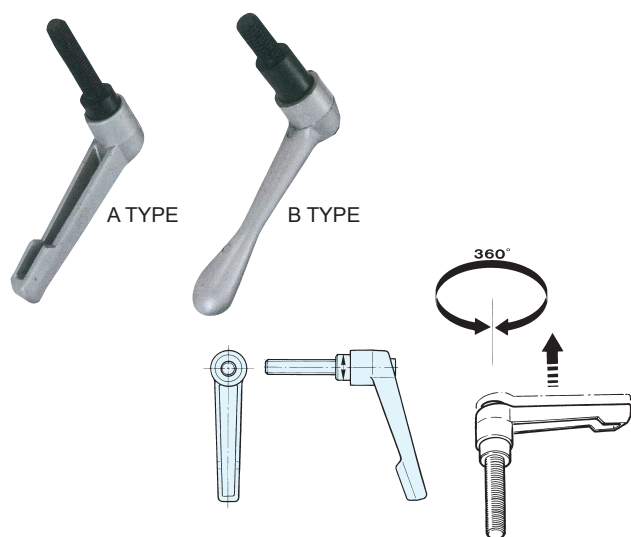

ORDER NO.	SIZE	CODE NO.
VSA-1	M6 x 1.0P x 30L	7003-300A
VSA-2	M8 x 1.25P x 30L	7003-301A
VSA-3	M10 x 1.5P x 30L	7003-302A
VSA-4	M12 x 1.75P x 30L	7003-302B
VSB-1	M6 x 1.0P x 30L	7003-303A
VSB-2	M8 x 1.25P x 30L	7003-304A
VSB-3	M10 x 1.5P x 30L	7003-305A
VSB-4	M12 x 1.75P x 30L	7003-305B

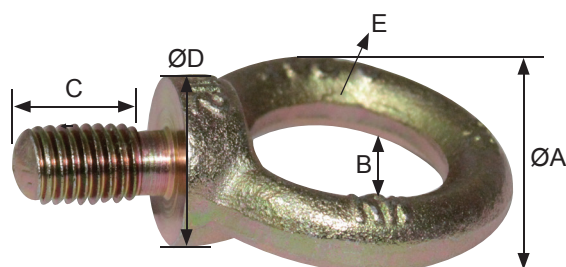

Lifting Eye Ring

SS400 IRON

ORDER NO.	SIZE	ALLOWED LOAD (kg)	A	B	C	D	CODE NO.
VLE-6A	M6 x 1.0P	60	33	20	15	17	7003-321A
VLE-8A	M8 x 1.25P	80	34	20	15	17	7003-322A
VLE-10A	M10 x 1.5P	128	41	25	18	20	7003-323A
VLE-12A	M12 x 1.75P	187	50	30	20	25	7003-324A
VLE-14A	M14 x 2.0P	255	60	34	27	29	7003-325A
VLE-16A	M16 x 2.0P	383	60	35	28	30	7003-326A
VLE-18A	M18 x 2.5P	535	71	40	31	34	7003-327A
VLE-20A	M20 x 2.5P	535	71	40	31	35	7003-328A
VLE-22A	M22 x 2.5P	808	90	48	38	47	7003-329A
VLE-24A	M24 x 3.0P	808	92	50	38	47	7003-330A

Shoulder Locating Unit



MOQ:1 BOX = 12 PCS

Unit : mm

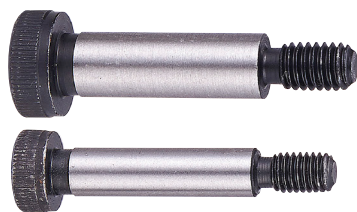

For lathe chuck

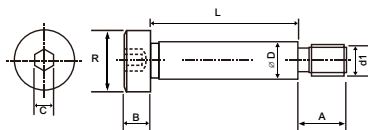

ORDER NO.	A±0.05	B±0.05	C	øD	R	L	d1	WEIGHT KGS	CODE NO.
VLS-1320	11	5.5	4	MAX. 7.951 MIN. 7.987	13	20	M6 X 1.0P		7003-335
VLS-1325						25			7003-336
VLS-1330						30			7003-337
VLS-1335						35			7003-338
VLS-1340						40			7003-339
VLS-1620	13	7.0	5	MAX. 9.951 MIN. 9.987	16	20	M8 X 1.25P		7003-340
VLS-1625						25			7003-341
VLS-1630						30			7003-342
VLS-1635						35			7003-343
VLS-1640						40			7003-344
VLS-1820	16	8.0	6	MAX. 11.941 MIN. 11.984	18	20	M10 X 1.5P		7003-345
VLS-1825						25			7003-346
VLS-1830						30			7003-347
VLS-1835						35			7003-348
VLS-1840						40			7003-349

Ring Plate

MOQ:1 BOX = 50 PCS

Unit : mm



ORDER NO.	SIZE D x d x T	BOX	WEIGHT KGS	CODE NO.
VLE-W226	Ø22 X Ø6.5 X 4 ^T	50 PCS		7003-353
VLE-W2210	Ø22 X Ø10.7 X 4 ^T	50 PCS		7003-354
VLE-W2511	Ø25 X Ø11.5 X 4 ^T	50 PCS		7003-355
VLE-W2512	Ø25 X Ø12.8 X 4 ^T	50 PCS		7003-356
VLE-W3212	Ø32 X Ø12.8 X 4 ^T	50 PCS		7003-357
VLE-W3215	Ø32 X Ø15.9 X 4 ^T	50 PCS		7003-358
VLE-W3515	Ø35 X Ø15.9 X 4 ^T	50 PCS		7003-359

Crank Handle



ORDER NO.	A	L	mm	Weight kgs	CODE NO.
VAH-21	31	147	15	0.49	7003-460
VAH-22	41	183	16.5	0.64	7003-461
VAH-23	54	231	21	1.08	7003-462

ORDER NO.	A	L	mm	Weight kgs	CODE NO.
VAH-31	37	180	14	0.48	7003-470
VAH-32	37	250	14	0.62	7003-471

SPECIAL USAGE MACHINE



Ball Plugger Screw-Socket & Slotted

**VERTEX®**

Material : SCM435 / 302HQ

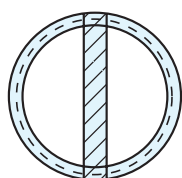
Hardness : HRC40 \pm 3

I TYPE
SCREW DRIVER SL

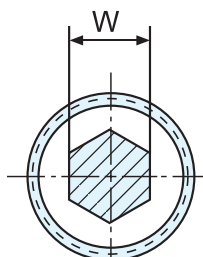

H TYPE
HEX. SET TYPE

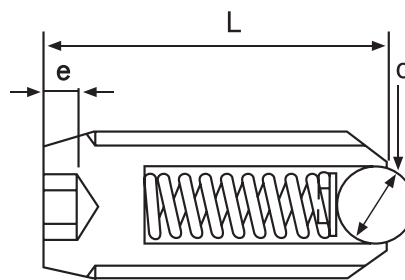

ORDER NO.	D	pitch	d	L	e	W	Light		Heavy		CODE NO.
							min	Max	min	Max	
VBP-03I	M3	0.5	1.5	7	1.0	1.5	1.0	2.0	1.5	2.9	7003-400A
VBP-04I	M4	0.7	2.5	9	1.5	2.0	2.0	4.9	3.9	9.8	7003-401A
VBP-05I	M5	0.8	3.0	12	2.0	2.5	2.9	9.8	4.9	19.6	7003-402A
VBP-06I	M6	1.0	3.5	13	2.5	3.0	4.9	14.7	9.8	29.4	7003-403A
VBP-08I	M8	1.25	5.0	15	2.5	4.0	6.9	19.6	12.7	39.2	7003-404A
VBP-10I	M10	1.5	6.0	16	3.0	5.0	8.8	24.5	18.6	49.0	7003-405A
VBP-12I	M12	1.75	8.0	22	3.0	6.0	9.8	29.4	19.6	58.8	7003-406A
VBP-16I	M16	2.0	10	25	3.0	8.0	15.7	49.0	29.4	98.0	7003-407A

VBP-03H	M3	0.5	1.5	7	1.0	1.5	1.0	2.0	1.5	2.9	7003-400B
VBP-04H	M4	0.7	2.5	9	1.5	2.0	2.0	4.9	3.9	9.8	7003-401B
VBP-05H	M5	0.8	3.0	12	2.0	2.5	2.9	9.8	4.9	19.6	7003-402B
VBP-06H	M6	1.0	3.5	13	2.5	3.0	4.9	14.7	9.8	29.4	7003-403B
VBP-08H	M8	1.25	5.0	15	2.5	4.0	6.9	19.6	12.7	39.2	7003-404B
VBP-10H	M10	1.5	6.0	16	3.0	5.0	8.8	24.5	18.6	49.0	7003-405B
VBP-12H	M12	1.75	8.0	22	3.0	6.0	9.8	29.4	19.6	58.8	7003-406B
VBP-16H	M16	2.0	10	25	3.0	8.0	15.7	49.0	29.4	98.0	7003-407B



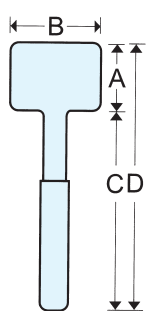

BASIC: Steel structure and include steel shot.

MATERIALS: Main of the anti-pollution PU-liquid.
The holder use soft quality TPR.

FEATURE:PU not make with heavy-metal and dioxin when burning.

HARDNESS: Hardness of hammer (90A~95A)
Color may be varied.

ORDER NO.	A	B	C	D	Weight (g)	OZ	CODE NO.
VHM-38	38	100	249	287	490	18oz	7003-367
VHM-46	46	100	260	306	690	24oz	7003-368
VHM-50	50	110	290	340	930	33oz	7003-369
VHM-56	56	120	297	353	1160	41oz	7003-370
VHM-60	60	130	308	368	1370	49oz	7003-371



Hammer





- Strike face uses UPE materials.
- Recyclable TPV holder.
- Strike face is inter-changeable

ORDER NO.	A	B	C	D	Weight (g)	OZ	CODE NO.
VHM-25PE	25	110	250	275	450	15oz	7003-380
VHM-30PE	30	110	250	280	480	16oz	7003-381
VHM-35PE	35	110	245	280	590	20oz	7003-382
VHM-40PE	40	120	260	300	850	29oz	7003-383
VHM-45PE	45	120	260	305	990	38oz	7003-384
VHM-50PE	50	125	265	315	1110	42oz	7003-385
VHM-55PE	55	135	265	320	1316	46oz	7003-386
VHM-60PE	60	140	265	320	1650	55oz	7003-387

Hammer Head



PARTS:

unit : mm

ORDER NO.	PIPE	CODE NO.
VHM-25H	25	7003-390
VHM-30H	30	7003-391
VHM-35H	35	7003-392
VHM-40H	40	7003-393
VHM-45H	45	7003-394
VHM-50H	50	7003-395
VHM-55H	55	7003-396
VHM-60H	60	7003-397



Universal Drill & Cutter Grinder

**VERTEX®**

ORDER NO.VDG-32N CODE NO.8001-010



Double cams: The cam of grinding drills & The cam of grinding taps.

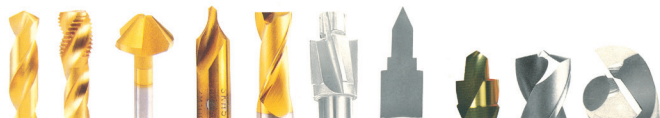

FEATURES

- Grinding capacity: Ø1.5~Ø32mm (Straight shank & taper shank) double wheels. It only need to rotate the motor when want to grind the tool of different material. It can increase the safety & save the time for changing & repairing the grinding wheel.
- The kinds of grinding tool include: drills, step drills, taps, lips of end mills, round bars, etc.
- Adopts precision 4" 6 jaws self-centering chuck, clipping one time. It can grind the blade of drills and do the paring of drills abdomen. The angle of drills both sides and the length of the blade are the same after grinding. It can keep the accuracy of the center of drills without off center.

OPTIONAL:

VDG-32N-WHEEL-SDC
145D #200

Longitudinal travel of table	120mm
Cross travel of saddle	135mm
Rotary angle of wheel head	360°
Point angle	90°-180°
Size of wheel	125x50x31.75mm
Speed of wheel	3600 RPM
Motor	3/4HP, 110V/220V/380V
N.W. / G.W.	90kgs/120kgs
Size of packing (LxWxH)	800x550x670mm

※Guaranteed for 3 months

※Color may vary



Horizontal Band Saw

ORDER NO.HBS-7 CODE NO.8001-030



※Please notify the voltage & phase when you ordering.

※Color may vary

SPECIFICATION

Capacity	●180mm (7") ■180x300mm (7"x12")
Blade size	19x0.9x2360mm (3/4"x0.32x7'9")
Motor	1HP 4pole 50HZ/1430rpm; 60HZ/1720rpm
Blade speed	22, 33, 45, 65mpm (86-132-178-260fpm)
Machine dim	L1470xW430mm (L58"xW17") H990mm (39") horizontal position.
N.W.	130kgs (286LBS)
G.W.	150kgs (341LBS)
Voltage	220V/3PH ,380V/3PH