



H.S.S. DRILL

**VERTEX®****NEW**

With Coating



Ø1.0, 1.5, 2.0, 2.5, 3.0, 3.5, 4.0, 4.5, 5.0, 5.5,
6.0, 6.5, 7.0, 7.5, 8.0, 8.5, 9.0, 9.5, 10 mm

※HSD-10 Ø1~Ø10MM 19PCS / SET
EACH ONE STEP 0.5MM

Ø1.0, 1.5, 2.0, 2.5, 3.0, 3.5, 4.0, 4.5, 5.0, 5.5, 6.0,
6.5, 7.0, 7.5, 8.0, 8.5, 9.0, 9.5, 10, 10.5, 11, 11.5,
12, 12.5, 13 mm

※HSD-13 Ø1~Ø13MM 25PCS / SET
EACH ONE STEP 0.5MM

ORDER NO.	PCS / SET	WEIGHT (kgs)	CODE NO.
HSD-10	19 PCS	0.7	6010-001
HSD-13	25 PCS	1.3	6010-002



Hand Taps

JIS STANDARD



Tis Standard

NEW

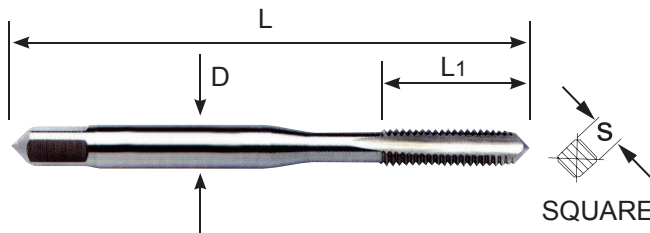

JIS

HSS

60°

6H

ORDER NO.	SIZE x PITCH	ØD	S	L	L1	WEIGHT (kgs)	CODE NO.
VHT-H3	M3 x 0.5P	4	3.2	46	18		6011-001
VHT-H4	M4 x 0.7P	5	4	52	20	0.01	6011-002
VHT-H5	M5 x 0.8P	5.5	4.5	60	22		6011-003
VHT-H6	M6 x 1.0P	6	4.5	62	24		6011-004
VHT-H8	M8 x 1.25P	6.2	5	70	30	0.03	6011-005
VHT-H10	M10 x 1.5P	7	5.5	75	32	0.05	6011-006
VHT-H12	M12 x 1.75P	8.5	6.5	82	38		6011-007
VHT-H14	M14 x 2.0P	10.5	8	88	42		6011-008
VHT-H16	M16 x 2.0P	12.5	10	95	45		6011-009
VHT-H20	M20 x 2.5P	15	12	105	50		6011-010



Spiral Fluted Machine Taps

NEW

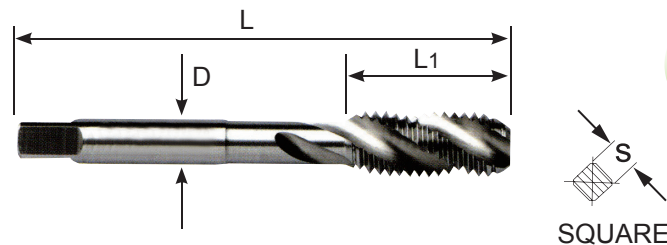

Spiral Fluted

JIS

HSS-EV

60°

6H

ORDER NO.	SIZE x PITCH	ØD	S	L	L1	WEIGHT (kgs)	CODE NO.
VMT-S3	M3 x 0.5P	4	3.2	46	11	0.01	6011-021
VMT-S4	M4 x 0.7P	5	4	52	13	0.01	6011-022
VMT-S5	M5 x 0.8P	5.5	4.5	60	16	0.02	6011-023
VMT-S6	M6 x 1.0P	6	4.5	62	19	0.02	6011-024
VMT-S8	M8 x 1.25P	6.2	5	70	22	0.03	6011-025
VMT-S10	M10 x 1.5P	7	5.5	75	24	0.05	6011-026
VMT-S12	M12 x 1.75P	8.5	6.5	82	29	0.07	6011-027
VMT-S14	M14 x 2.0P	10.5	8	88	30		6011-028
VMT-S16	M16 x 2.0P	12.5	10	95	32	0.08	6011-029
VMT-S20	M20 x 2.5P	15	12	105	37		6011-030



Spiral Fluted Machine Taps

NEW

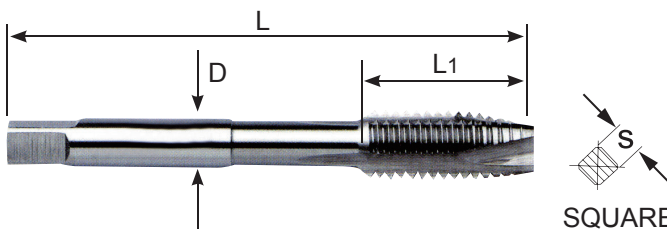

JIS

HSS-EV

60°

6H

ORDER NO.	SIZE x PITCH	ØD	S	L	L1	WEIGHT (kgs)	CODE NO.
VMT-M3	M3 x 0.5P	4	3.2	46	11		6011-041
VMT-M4	M4 x 0.7P	5	4	52	13	0.01	6011-042
VMT-M5	M5 x 0.8P	5.5	4.5	60	16	0.02	6011-043
VMT-M6	M6 x 1.0P	6	4.5	62	19		6011-044
VMT-M8	M8 x 1.25P	6.2	5	70	22		6011-045
VMT-M10	M10 x 1.5P	7	5.5	75	24		6011-046
VMT-M12	M12 x 1.75P	8.5	6.5	82	29		6011-047
VMT-M14	M14 x 2.0P	10.5	8	88	30		6011-048
VMT-M16	M16 x 2.0P	12.5	10	95	32		6011-049
VMT-M20	M20 x 2.5P	15	12	105	37		6011-050

HAND TAPS



Hand Taps

ISO STANDARD



NEW

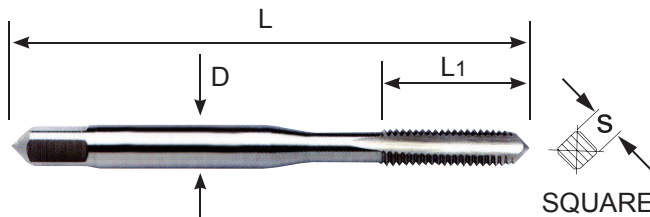

ISO 2
6H

HSS

60°

ISO
529/2283

ORDER NO.	SIZE x PITCH	ØD	S	STANDARD		L	L ₁	WEIGHT (kgs)	CODE NO.
VHT-H3-ISO	M3 x 0.5P	3.15	2.15	ISO529 M3	ISO529 2283 M4	46	18		6011-061
VHT-H4-ISO	M4 x 0.7P	4.0	3.15	ISO529 M4	ISO529 2283 M5	52	20	0.01	6011-062
VHT-H5-ISO	M5 x 0.8P	5.0	4.0	ISO529 M5		60	22		6011-063
VHT-H6-ISO	M6 x 1.0P	6.3	5.0	ISO529 M6	ISO529 2283 M8	62	24		6011-064
VHT-H8-ISO	M8 x 1.25P	8.0	6.3	ISO529 M8	ISO529 2283 M10	70	30	0.03	6011-065
VHT-H10-ISO	M10 x 1.5P	10.0	8.0	ISO529 M10		75	32	0.05	6011-066
VHT-H12-ISO	M12 x 1.75P	9.0	7.1		ISO529 2283 M12	82	38		6011-067
VHT-H14-ISO	M14 x 2.0P	11.2	9.0		ISO529 2283 M14	88	42		6011-068
VHT-H16-ISO	M16 x 2.0P	12.5	10.0		ISO529 2283 M16	95	45		6011-069
VHT-H20-ISO	M20 x 2.5P	14.0	11.2		ISO529 2283 M20	105	50		6011-070



Spiral Fluted Machine Taps

NEW

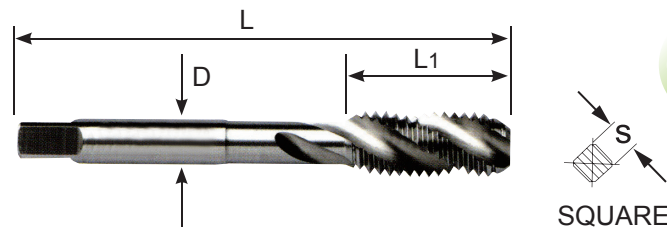

Spiral
Fluted

ISO 2
6H

HSS-EV

60°

ISO
529/2283

ORDER NO.	SIZE x PITCH	ØD	S	STANDARD		L	L ₁	WEIGHT (kgs)	CODE NO.
VMT-S3-ISO	M3 x 0.5P	3.15	2.15	ISO529 M3	ISO529 2283 M4	46	11	0.01	6011-081
VMT-S4-ISO	M4 x 0.7P	4.0	3.15	ISO529 M4	ISO529 2283 M5	52	13	0.01	6011-082
VMT-S5-ISO	M5 x 0.8P	5.0	4.0	ISO529 M5		60	16	0.02	6011-083
VMT-S6-ISO	M6 x 1.0P	6.3	5.0	ISO529 M6	ISO529 2283 M8	62	19	0.02	6011-084
VMT-S8-ISO	M8 x 1.25P	8.0	6.3	ISO529 M8	ISO529 2283 M10	70	22	0.03	6011-085
VMT-S10-ISO	M10 x 1.5P	10.0	8.0	ISO529 M10		75	24	0.05	6011-086
VMT-S12-ISO	M12 x 1.75P	9.0	7.1		ISO529 2283 M12	82	29	0.07	6011-087
VMT-S14-ISO	M14 x 2.0P	11.2	9.0		ISO529 2283 M14	88	30		6011-088
VMT-S16-ISO	M16 x 2.0P	12.5	10.0		ISO529 2283 M16	95	32	0.08	6011-089
VMT-S20-ISO	M20 x 2.5P	14.0	11.2		ISO529 2283 M20	105	37		6011-090



Spiral Fluted Machine Taps

NEW

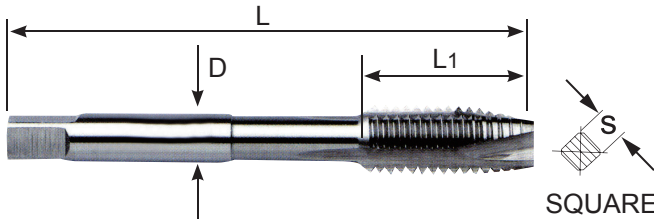

ISO 2
6H

HSS-EV

60°

ISO
529/2283

ORDER NO.	SIZE x PITCH	ØD	S	STANDARD		L	L ₁	WEIGHT (kgs)	CODE NO.
VMT-M3-ISO	M3 x 0.5P	3.15	2.15	ISO529 M3	ISO529 2283 M4	46	11		6011-101
VMT-M4-ISO	M4 x 0.7P	4.0	3.15	ISO529 M4	ISO529 2283 M5	52	13	0.01	6011-102
VMT-M5-ISO	M5 x 0.8P	5.0	4.0	ISO529 M5		60	16	0.02	6011-103
VMT-M6-ISO	M6 x 1.0P	6.3	5.0	ISO529 M6	ISO529 2283 M8	62	19		6011-104
VMT-M8-ISO	M8 x 1.25P	8.0	6.3	ISO529 M8	ISO529 2283 M10	70	22		6011-105
VMT-M10-ISO	M10 x 1.5P	10.0	8.0	ISO529 M10		75	24		6011-106
VMT-M12-ISO	M12 x 1.75P	9.0	7.1		ISO529 2283 M12	82	29		6011-107
VMT-M14-ISO	M14 x 2.0P	11.2	9.0		ISO529 2283 M14	88	30		6011-108
VMT-M16-ISO	M16 x 2.0P	12.5	10.0		ISO529 2283 M16	95	32		6011-109
VMT-M20-ISO	M20 x 2.5P	14.0	11.2		ISO529 2283 M20	105	37		6011-110



Tap Wrenches With Ratchet





CLAMPING RANGE

NEW



Unit : mm

ORDER NO.	SIZE	METRIC	L	MAX. 	MIN. 	WEIGHT (kgs)	CODE NO.
VPW-310	1	M3~M10	85	5.5	3.0	0.18	6011-801
VPW-512	2	M5~M12	100	7.0	4.5	0.31	6011-802



Tap Wrenches With Ratchet

CLAMPING RANGE



NEW

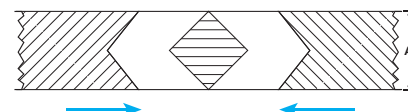

$$A = x \cdot 1.414$$



Unit : mm

ORDER NO.	SIZE	FOR METRIC	A 	MAX.B 	MIN.B 	PIPE PT/ PF-	L	WEIGHT (kgs)	CODE NO.
VPW-118	0	M1~M8	7.3	5.0	2.5	PT-1/16	125	0.06	6011-811
VPW-110	1	M1~M10	8.2	5.5	2.2	PT-1/16	180	0.12	6011-812
VPW-112	1-1/2	M1~M12	8.3	6.5	2.2	PT-1/8	200	0.11	6011-813
VPW-412	2	M4~M15	11.5	8.0	3.3	PT-1/8	280	0.26	6011-814
VPW-520	3	M5~M20	17.5	12.0	4.1	PT-3/8	375	0.58	6011-815
VPW-927	4	M9~M27	18.4	15.0	6.1	PF-5/8	500	0.86	6011-816
VPW-1332	5	M13~M27	22.2	15.0	5.7	PF-5/8	750	1.36	6011-817



Magnetic Tapper

NEW



COST HIGHER



EXAMPLE



- Suit for large workpiece
- TAP thread capacity M3-M12
- MAX. stroke 60 mm
- Magnetic force 80 kgf
- Horizontal / Vertical
- Portable
- Great for machine case & thin plate tapping job.

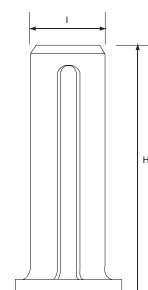
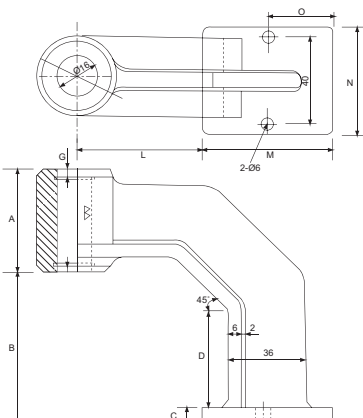

Unit : mm

● Tap & work piece not included

ORDER NO.	A	B	C	D	H	I	L	M	N	O	WEIGHT (kgs)	CODE NO.
VTM-13	50	72	10	45	122	36	60	60	50	30	3.10	2015-731

CUTTING TOOL F50

HAND TAPS